



YUNG DESIGN GROUP^{INC.}
CREATIVE DEVELOPMENT SOLUTIONS



YUNG DESIGN GROUP, INC.

BACKGROUND

The Yung Design Group Inc. was established in 1975 to provide Landscape Architectural Services and Land Planning Services for select clientele seeking innovative solutions to Land Development problems. The firm was established in Wichita, Kansas, primarily to relate to an existing client base.

From this beginning, the Yung Design Group Inc. has carefully grown, and in 1993, we made the decision to move our corporate offices to Branson, Missouri. Our client base continues to grow, and many of our clients continue to use us for nearly every project they do today. The growth has been controlled and accomplished within the ethical guidelines we originally established when we began.

The Yung Design Group Inc. is comprised of a group of professional Landscape Architects, Land planners, graphic artists and a supporting staff of draftsmen, computer operators, clerical and office management. Our full time staff of seven is well trained and very efficient. This allows our firm to meet our clients' needs in a timely fashion and within budget. To be successful in business, we found it important to recognize that the clients' time table is more important than ours, so we adapt.

Our firm's strengths include Landscape Architecture, Land Planning and Marketing Graphics. We have made it a practice to provide only these services and to serve our clients well, rather than try to provide all the design services a project often requires. We work very closely with architects, project engineers, golf course architects, marketing specialists, and other consultants, but have elected not to include them on our staff. This, we believe, provides our clients the opportunity to select their choice of firms, for each of the other design services needed and to establish their own design team for their project. Throughout our firms history, we have specialized in quality of service rather than quantity of services offered. This style of business allows for the principal and key staff members to work closely with our clients on a day to day basis. This hands on approach insures that the most experienced staff is attending to the problem solving process.

DESIGN PHILOSOPHY

We are noted for creatively designed solutions, fair play and fair prices that will stand up to the final test: the market place. We approach each project based on its own set of individual problems or opportunities. Each project has it own unique conditions, which if properly managed and understood, can create the opportunity for an environmentally sensitive, highly competitive and marketable project.

It is our philosophy that a well conceived plan should honor existing environmental conditions, be cost effective, market oriented and above all flexible to accommodate market shifts. It should relate to the specific needs of any environment whether it be a place to live, work, shop or play.





SERVICES OFFERED

We generally provide design services in connection with engineering and marketing consultants, allowing our input to provide a unique interpretation of our clients' goals and objectives, culminating in a plan for development containing 'State of the Art' concepts.

The Yung Design Group Inc. has represented many clients, some continuously, for the past 30 years and has designed projects totaling well over 130,000 acres.

The services we offer generally relate to a blend of Landscape Architecture, Land Planning and sales orientated Marketing Graphics. The specific list of services is as follows:

- Land Use Studies
- Architectural Animation
- Computer Graphics
- Facility Planning
- Sculptural Grading Plans
- Site Specific Planning
- Master Plans and Development Plans
- Public Presentations
- Sales Maps
- Architectural Renderings
- Campus Planning
- CUP-PUD and Planned Districts
- Interior and Exterior Landscape Plans
- Master Plans
- Park Planning
- Preliminary Planning
- Project Theming
- Redevelopment Studies
- Zoning

WWW.YUNGDESIGN.COM
INFO@YUNGDESIGN.COM





BILL G. YUNG
PRESIDENT • YUNG DESIGN GROUP, INC

EDUCATION

Bachelor of Science, Landscape Architecture

Kansas State University, 1964

Master Of Science, Landscape Architecture

Kansas State University, Jan. 1965

REGISTERED LANDSCAPE ARCHITECT

EXPERIENCE

Mr. Yung is a registered Landscape Architect with major experience in the fields of land planning, urban redevelopment, zoning, land use controls, platting, parks and recreation, facility planning and the preparation of marketing graphics.



ROBERT BUTIN
VICE PRESIDENT, DIRECTOR OF LANDSCAPE ARCHITECTURE

EDUCATION

Bachelor of Landscape Architecture
Kansas State University, 1978
REGISTERED LANDSCAPE ARCHITECT

EXPERIENCE

1976 - Present Vice-President - Yung Design Group, INC.



BRAD HOFFMAN
DIRECTOR OF LAND PLANNING

EDUCATION

Bachelor of Landscape Architecture
Oklahoma State University, 1994
Mike Lin Graphics Workshop, 1992
REGISTERED LANDSCAPE ARCHITECT

EXPERIENCE

1994 - Present Director of Land Planning - Yung Design Group, INC.



RYAN TOW
DIRECTOR OF MARKETING GRAPHICS

EDUCATION

Bachelor of Landscape Architecture
Iowa State University, 1997
GRADUATE LANDSCAPE ARCHITECT
Computer Graphics Specialist

EXPERIENCE

1997-Present Director of Marketing Graphics - Yung Design Group, INC.





STEPHANIE DEAN

GRADUATE LANDSCAPE ARCHITECT

EDUCATION

Bachelor of Landscape Architecture
Natural Resources and Environmental Sciences
Kansas State University, 2006

EXPERIENCE

2004-Present Yung Design Group, Inc.



JOHN HICKMAN

COMPUTER GRAPHIC ARTIST

EDUCATION

Bachelor of Arts, Communication
Waldorf College, 2001

EXPERIENCE

2005 - Present Yung Design Group, INC.
2001-2005 Brackett Media & Event Services, Des Moines, Iowa



JUSTIN RANKIN

COMPUTER DRAFTSMAN /DESIGN SUPPORT

EDUCATION

St. Charles Community College - Computer Drafting
Ozark Technical College - Business

EXPERIENCE

2002 - Present Yung Design Group, INC.

MAGGIE YUNG

SECRETARY & TREASURER, YUNG DESIGN GROUP, INC.

EDUCATION

Bachelor of Science, Education
Speech & English
Emporia State University, 1961

EXPERIENCE

1986 - Present Yung Design Group, INC.



SHERRY MCNELIS

OFFICE SUPPORT & ADMINISTRATION

EXPERIENCE

2006 - Present Yung Design Group, INC.

EDUCATION

Jacksonville Community College, 1987
Business Administration



FEATURE PROJECTS

We have a history of many successful projects and satisfied clients; from both aesthetic and financial considerations. Our track record and our list of satisfied clients is our best form of advertising. The following list is representative of the projects completed. It represents the larger projects completed and many of the services we offer were also provided on the same projects.

MASTER PLANS

- **Comotara Master Plan** *Wichita, KS*
- **Country Club of the Ozarks Master Plan** *Branson, MO*
- **Embassy Park Master Plan** *Kansas City - MO*
- **Falcon Ridge Golf Course Dev. Master Plan** *Lenexa, KS*
- **Fall Creek Resort Master Plan** *Branson, MO*
- **Golf Course Development Master Plan** *Breckenridge, CO*
- **Holiday Hills Resort and Golf Club Master Plan** *Branson, MO*
- **Lakepoint Master Plan** *Wichita, KS*
- **Money Hill Golf Course Development - Master Plan** *Covington, LA*
- **Reflection Ridge - Golf Course Development Master Plan** *Wichita, KS*
- **Pizza Hut Headquarters Master Landscape Plan** *Wichita, KS*
- **Rivercut Golf Course Dev. Master Plan** *Springfield, MO*
- **SweetBay Master Plan** *Long Beach, MS*
- **Tallgrass Golf Course Development Master Plan** *Wichita, KS*
- **The Falls Commercial Master Plan** *Branson, MO*
- **Timber Lakes Master Plan Development** *Bonner Springs - KS*
- **Twin Oaks Estates Master Plan** *Springfield, MO*
- **Westberry Farms Master Plan** *Joplin, MO*
- **Whispering Meadows** *Independence, MO*
- **Willowbrook Patio Homes Master Plan** *Overland Park, KS*
- **Grey Oaks, Rodrock Development** *Lenexa, KS*
- **Powers Executive Center** *Colorado Springs, CO*
- **The Sanctuary** *Branson, MO*
- **Hollister Commercial Entertainment Center** *Hollister, MO*
- **Dogwood Centre Commercial** *Lake of the Ozarks, MO*
- **The Summit Golf Course Dev.** *Fuzhou, China*
- **Woodsonia West - Rodrock** *Lenexa, KS*
- **FoxBerry Estates** *Lake Lotawana, MO*
- **Copperleaf Residential Dev.** *Nixa, MO*
- **Oak Cliffe Golf Course Dev.** *Nixa, MO*
- **Central Park Residential Dev.** *Wichita, KS*
- **Table Rock Canyon** *Hollister, MO*
- **Iron Horse Residential Community** *Oklahoma City, OK*

RESORT PLANNING

- **Fairfield Communities Timeshare Projects**
Fairfield at the Meadows - Branson
Fairfield at the Falls - Branson, MO
Fairfield Nashville, TN
Governors Crossings - Seville, TN
- **Sunterra Timeshare Project**
Plantation Resort - Branson, MO
- **Silverleaf Resorts Timeshare Projects**
Fox River Resort, near Chicago, IL
Timber Creek Resort - St. Louis, MO
Holley Lake, TX
The Villages, TX
Lake of the Woods, TX
Las Vegas, NV
Hill Country, TX
Holiday Hills - Branson, MO
Ozark Mtn. Resort - Kimberling City, MO
Piney Shores, TX
Apple Mountain Resort, GA
Oak and Spruce Resort, MA
Beech Mountain Resort, PA
Brookdale Resort, MA
Snowy Owl Resort, MA
- **Peppertree Resorts Timeshare projects**
Georgetown - Branson, MO
Peppertree at Thousand Hills - Branson, MO
- **Grandvista Resorts Timeshare Projects**
The Woods Resort - Branson, MO
Emerald Pointe - Branson, MO
Rock Lane Resort - Branson, MO
Painted Mountain - Mesa, AZ
Tunica Resort - Tunica, MS
- **Surrey Vacation Resorts Timeshare projects**
Surrey Vacation Resort - Branson, MO
Surrey Grand Crowne Resort - Branson, MO
- **Quintus Resorts Timeshare Project**
Paradise Point Resort - Branson, MO
- **Palace View Condominiums Project - Branson, MO**
- **Thousand Hills Condominium Project 5 in Branson, MO**
- **Fall Creek Resort - Branson, MO**
- **Festiva Resorts - Branson, MO**
- **Old Hawthorne Golf Course Community - Columbia, MO**
- **Indian Ridge Resort Community - Branson West, MO**
- **Windemere Resort - Lake of the Ozarks, MO**
- **Fall Creek Resort - Branson, MO**
- **French Quarter Timeshare - Branson, MO**

LANDSCAPE PLANNING

- McConnell Air National Guard Main Entrance - Wichita, KS
- John Q. Hammons Hotels - Interior Atrium Landscape Plans
- Tampa, Coral Springs & St. Augustine, FL, Portland, OR, Sioux Falls, SD, Grapevine TX, Oklahoma City, OK, Lincoln, NE, Charlotte, NC, North Charleston, SC, Tulsa, OK and Topeka, KS
- Hammons Hotels - Exterior Landscape Plan, Chateau on the Lake, Branson, MO and Mesquite, TX
- McPherson College - McPherson, KS
- Veterans Administration Domiciliary - Leavenworth, KS
- Wellington Park Master Plan - Overland Park, KS
- Branson Landing - Branson, MO
- Convention Center, Hilton Hotel Complex, Branson, MO
- Welk Resort, Branson, MO

MARKETING GRAPHICS

- 1601 Jefferson Condominiums - Kansas City, MO
- Stone Water Cove Resort - Table Rock Lake, MO
- Northgate Corporate Village - Colorado Springs, CO
- The Estates at Point Happy Ranch - La Quinta, CA
- Wells Fargo Home Mortgage Campus - West Des Moines, IA
- Commerce Park - Clive, IA
- Silverleaf Resorts - Twelve Resort Sites in Six States
- Grey Oaks Development - Shawnee, KS
- French Quarter Resort - Branson, MO
- The Crosswinds Business Park - Ankeny, IA
- Branson Recreation Center - Branson, MO
- Applebee's Prototype Restaurant - Frisco, TX
- Pinnacle Casino Resort - Kansas City, Kansas

PRINCIPAL CLIENTELE

Regarding our principal Clientele and their attitude regarding of our abilities, we suggest you contact them. The following list is representative of those we have served.

- Darren Abbott - Branson, MO
- Nick Blasi - Kansas City, MO
- John Redford - Branson, MO
- Bluegreen - Jeffery Jackard or Dave Maddix - Branson, MO
- Dale Janssen - Joplin, MO
- Darol Rodrock - Overland Park, KS
- Darrell Gross - Springfield, MO
- Dan Ruda - Branson, MO
- David Goodyear - Covington, LA
- Dale Beggs - Colorado Springs, CO
- Ed Davis - Amarillo, TX

- Bill Grebe - Castle Rock, CO
- Ed Pinegar - Springfield, MO
- Fairfield Communities, Brian Keller, Little Rock - AR
- HCW Development- Rick Huffman - Branson, MO
- Four Seasons Resort - Lane Roberts - Osage Beach, MO
- French Enterprises, Tom French - Overland Park, KS
- Rivercut Golf Course Dev. Gary Mitchell, - Springfield, MO
- Gary Snadon - Branson, MO
- Justin Gage - Hollister, MO
- Joe Holt - Lake Lotawana, MO
- Grant General Contractors, Inc., Jim Grant - Carlsbad, CA
- Jim Bay, Fairfield Communities - Nashville, TN
- J.D. Reece Co., Jerry Reece - Overland Park, KS
- JP Weigand Realtors, Nestor Weigand - Wichita, KS
- Jack Ashlock - Branson, MO
- John Q. Hammons Industries - Springfield, MO
- Gary Erickson - Colorado Springs, CO
- Jim Riffe - Kansas City, MO
- John Moore - Branson, MO
- John Redford - Branson, MO
- Bob Maddox - Branson, MO
- Louis Morgan - Joplin, MO
- Mark Weisz - Branson, MO
- Mark Williams - Branson, MO
- Steve Critchfield - Branson, MO
- Pat O'Reilly - Branson, MO
- Mission Bay - Tim Hinderman - Polson, MT
- Cushman Properties - David Cushman - Branson, MO
- Peterson Homes, Ken Riedeman - Lenexa, KS
- Gordon Garrett - Overland Park, KS
- Reflection Ridge, Inc., Reggie Boothe - Wichita, KS
- Ritchie Associates, Jack Ritchie - Wichita, KS
- Ron Middleton - Springfield, MO
- Ron Stenger - Springfield, MO
- Ryan Richardson - Branson, MO
- Rustom Ferzandi - Lenexa, KS
- Jim Shirato - Springfield, MO
- Sam Butcher, Precious Moments - Carthage, MO
- Sam Catanese - Wichita, KS
- Silverleaf Resorts, Robert Mead - Dallas, TX
- Slawson Investments, Don Slawson - Wichita, KS
- Sproul Construction Co., Dave Sproul - Wichita, KS
- John Gibson - Lone Summitt, MO
- Surrey Vacation Resorts - C.J. Perme - Branson, MO
- Tim Goostree - Joplin, MO
- Tom Tinsley, City Administrator - Waynesville, MO
- Wind River Dev. Corp. Larry Klinghoffer - Independence, MO

We at Yung Design Group Inc. would appreciate having the opportunity to add your name to the above list.

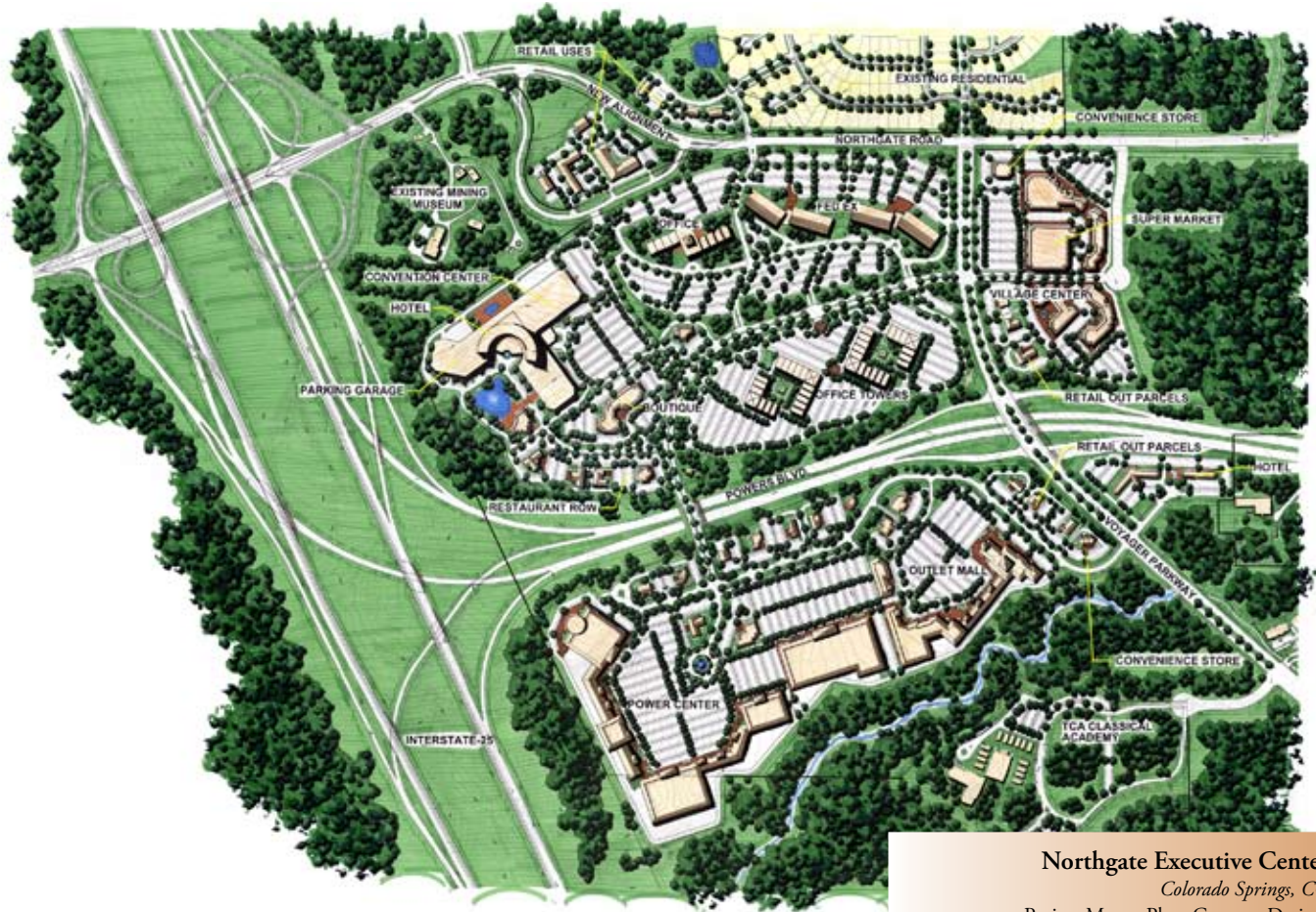

Northgate Executive Center
Colorado Springs, CO
Project Master Plan, Concept Design,
Animated Fly-over





Lodge-Themed Condo Interior
Illustration, Project Theming



Typical Single-Family Bungalow
Illustration, Project Theming



Summit Estates Clubhouse
Urbandale, Iowa
Conceptual Design & Illustration



Branson Landing

Branson, Missouri

Initial Design Concept, Preliminary Project
Visualization, Project Landscape Planning

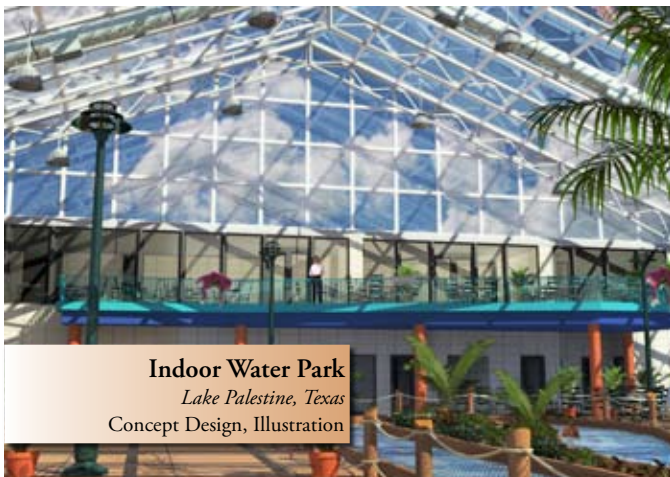

Indoor Water Park

Lake Palestine, Texas

Concept Design, Illustration



J.E. Dunn Headquarters

Kansas City, Missouri

Architectural Illustration



Wells Fargo Home Mortgage
West Des Moines, Iowa
Pre-Construction Animated Flyover



Vacation Ownership Condo
Various Resorts, & Locations
Design Proofing and Marketing Graphics



Summit Golf Course Development
Fuzhou, China
Project Master Planning, Preparation of Land
Use Documents





MASTERPLAN
DOGWOOD CENTRE

Dogwood Centre
Lake of The Ozarks, Missouri
Project Master Plan, Commercial Layout,
Creation of Colored Master Plan Document



Lodge-Themed Lakefront Condos
Illustration, Theming, Planning



Custom-Built Single Family Home
Marketing Illustration

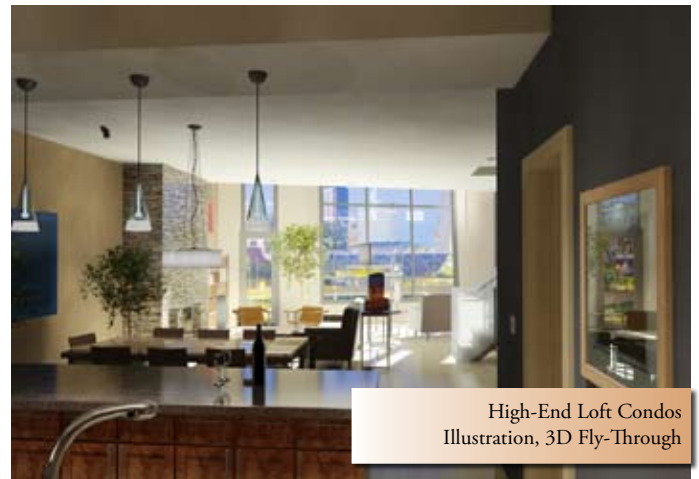

High-End Loft Condos
Illustration, 3D Fly-Through



Lone Jack Summit
Lee's Summit, Missouri
 Project Master Plan, Commercial Layout,
 Creation of Colored Master Plan Document





Lodge-Themed Lakefront Condos
Illustration, Theming, Planning





Proposed Lutheran-Myers Hospital
West Des Moines, Iowa
Illustration and Design Proofing



Missouri Tigers Golf Course
Columbia, Missouri
Project Master Plan, Golf Course Routing, Creation
of Colored Master Plan Document



- 0.4 DWELLING UNITS PER ACRE
- COMMUNITY PARK
- CENTRAL PARK
- NEIGHBORHOOD PARK
- LOCAL PARK
- CIVIC FACILITIES
- FIRE PROTECTION AND EMS
- SCHOOLS
- OFFICE
- MEDICAL
- DOWNTOWN COMMERCIAL
- GENERAL COMMERCIAL
- INDUSTRIAL
- EXISTING DEVELOPMENTS



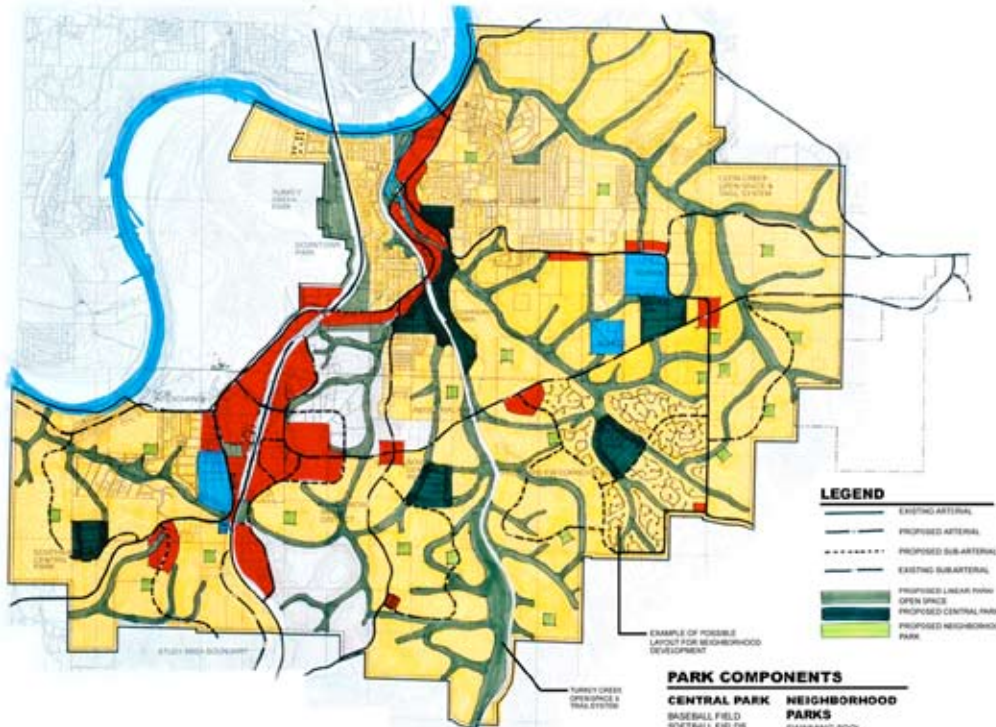

- LEGEND**
- EXISTING ARTERIAL
 - - - PROPOSED ARTERIAL
 - · · · · PROPOSED SUB-ARTERIAL
 - - - EXISTING SUB-ARTERIAL
 - PROPOSED LINEAR PARK
 - OPEN SPACE
 - PROPOSED CENTRAL PARK
 - PROPOSED NEIGHBORHOOD PARK

- PARK COMPONENTS**
- CENTRAL PARK**
- BASEBALL FIELD
 - SOFTBALL FIELDS
 - SOCCER FIELDS
 - TENNIS
 - SWIMMING POOL (INDOOR/OUTDOOR)
 - WATER PARK
 - BMA TRACK
 - SKATEBOARD PARK
 - SHUFFLEBOARD
 - HORSESHOES
 - BASKETBALL COURT
 - SPORTS COURT
 - WALKING TRAILS
 - FISHING PONDS
 - VOLLEYBALL
 - HANDBALL COURTS
 - PLAYGROUND
 - PICNIC SHELTERS
 - PICNIC SITES
- NEIGHBORHOOD PARKS**
- SWIMMING POOL
 - PLAYGROUND
 - PICNIC FACILITIES
 - MEASURED WALKWAYS
 - EXERCISE COURSES
 - BASKETBALL COURT
 - SPORTS COURT
- LINEAR PARKS**
- OPEN SPACE
 - NATURAL DRAINAGEWAYS
 - HIKE & BIKE TRAILS
 - EQUESTRIAN TRAILS
 - NEIGHBORHOOD PARK
 - PICNIC FACILITIES
 - ARCHERY RANGES
 - DISC GOLF COURSE
 - GOLF DRIVING RANGE

MAY 21, 2002
 REVISED OCTOBER 1, 2008

PARKS & RECREATION PLAN CITY OF HOLLISTER

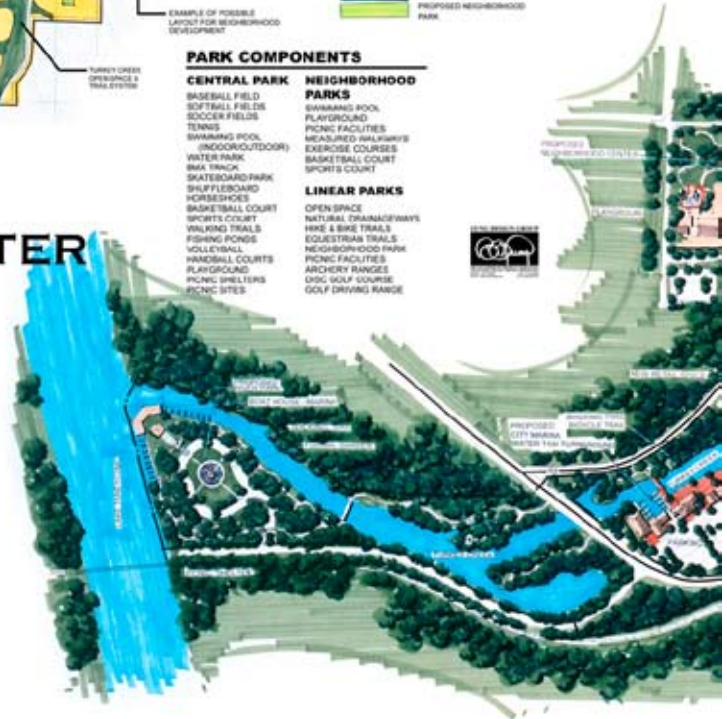

City of Hollister
 Hollister, Missouri
 Land Use Planning, Redevelopment District,
 Site-Specific Master Plans



PROPOSED COMMERCIAL RETAIL DISTRICT
CITY OF HOLLISTER

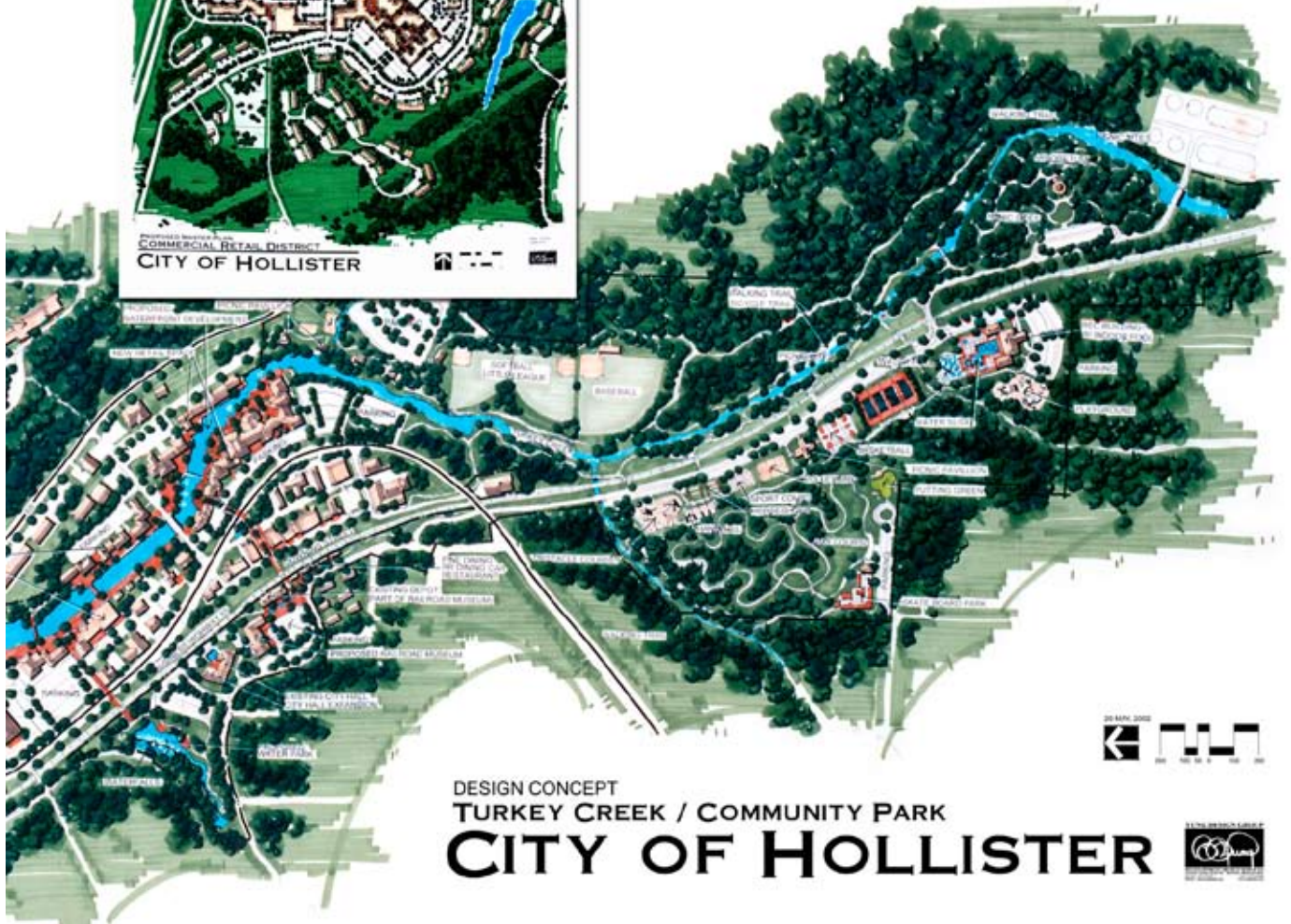
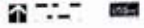

DESIGN CONCEPT
TURKEY CREEK / COMMUNITY PARK

CITY OF HOLLISTER







THIS PLAN IS A CONCEPTUAL ILLUSTRATION OF THE PROPOSED DEVELOPMENT. IT IS NOT A CONTRACT DOCUMENT. THE DEVELOPER AND ARCHITECT ASSUME NO LIABILITY FOR ANY ERRORS OR OMISSIONS. THE DEVELOPER AND ARCHITECT ASSUME NO LIABILITY FOR ANY ERRORS OR OMISSIONS. THE DEVELOPER AND ARCHITECT ASSUME NO LIABILITY FOR ANY ERRORS OR OMISSIONS.

MASTERPLAN
TABLE ROCK CANYON

Table Rock Canyon
Hollister, Missouri
Project Master Plan, Commercial Layout,
Planned Development Document, Illustration



The Sanctuary

Branson, Missouri

Project Master Plan, Project Theming, Illustration.
Planned Development Document



YUNG DESIGN GROUP, INC.

CREATIVE DEVELOPMENT SOLUTIONS

Corporate Headquarters
110 West Adams Street, Suite 102
Branson, Missouri 65616

voice: 417-335-8235
fax: 417-335-8286

www.yungdesign.com
info@yungdesign.com

Architectural Graphics Studio
10888 Hickman Road, Suite 3A
Clive, Iowa 50325

voice: 515-334-0555
fax: 515-334-7585